



STEPHENSON BROWNE

Coleridge Close, Sandbach

CW11 3NN



Offers Over £207,500

Description

This three-bedroom semi-detached family home is set on the cul-de-sac of Coleridge Close in the sought-after residential area of Ettiley Heath offers a perfect blend of comfort and convenience. The property boasts a spacious reception room, ideal for family gatherings or entertaining guests. The modern open-plan kitchen diner is a highlight, providing a welcoming space for culinary adventures and family meals.

The home features three well-proportioned bedrooms plus a family bathroom which caters to the needs of the household. With two storage cupboards throughout, you will find plenty of room to keep your belongings organised and tidy.

Outside, the property is equally impressive, with a driveway and an enclosed, low maintenance rear garden, offering a peaceful retreat for relaxation or outdoor activities without the burden of extensive upkeep.

This delightful home is perfect for families seeking a comfortable and practical living space in a friendly neighbourhood. With its modern amenities and generous parking, it presents an excellent opportunity for those looking to settle in Sandbach. Don't miss the chance to make this lovely property your new home.



Room Descriptions

Entrance Hall

6'4" x 3'3"

Living Room

14'11" x 9'10"

Kitchen Diner

13'0" x 8'1"

With sliding patio doors and an understairs storage cupboard.

Landing

8'4" x 6'3"

Bedroom One

13'0" x 8'2"

With storage cupboard.

Bedroom Two

8'11" x 6'5"

Bedroom Three

8'1" x 6'3"

Bathroom

6'5" x 5'8"

External

Driveway Parking for two vehicles. An enclosed, private and low maintenance garden to the rear.

AML Disclosure

Agents are required by law to conduct Anti-Money Laundering checks on all those buying a property. Stephenson Browne charge £49.99 plus VAT for an AML check per purchase transaction. This is a non-refundable fee. The charges cover the cost of obtaining relevant data, any manual checks that are required, and ongoing monitoring. This fee is payable in advance prior to the issuing of a memorandum of sale on the property you are seeking to buy.





Floorplans

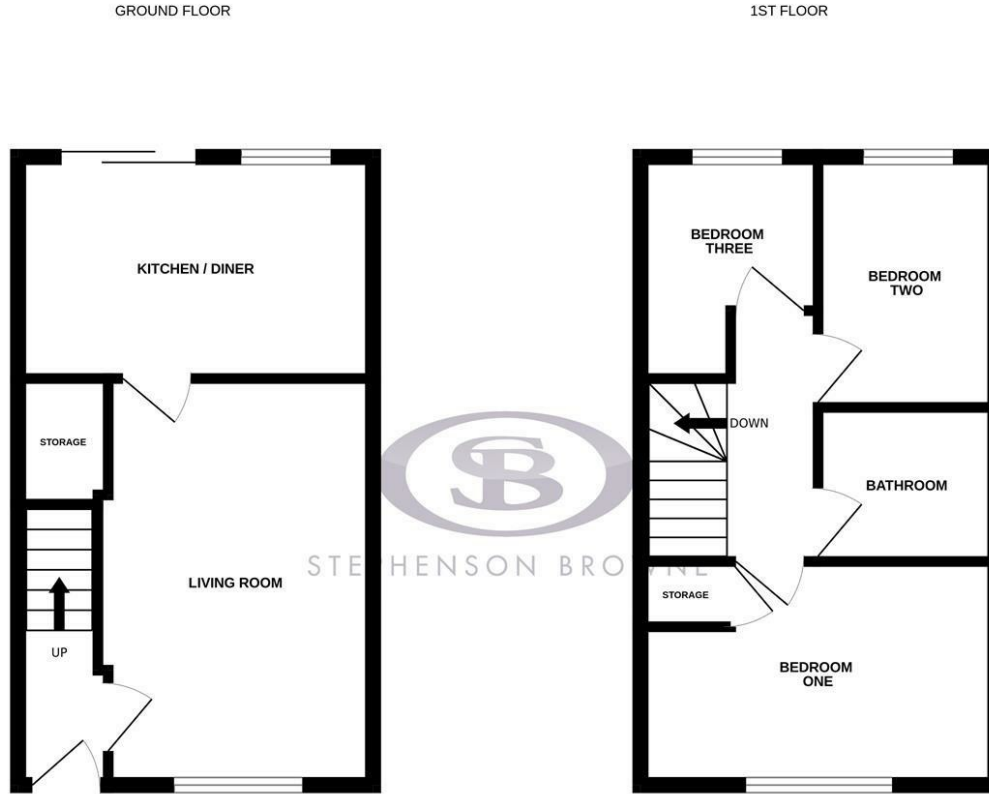

Whilst every attempt has been made to ensure the accuracy of the floorplan contained here, measurements of doors, windows, rooms and any other items are approximate and no responsibility is taken for any error, omission or mis-statement. This plan is for illustrative purposes only and should be used as such by any prospective purchaser. The services, systems and appliances shown have not been tested and no guarantee as to their operability or efficiency can be given. Made with Metropix ©2025

Area Map



EPC Rating

Energy Efficiency Rating		Environmental Impact (CO ₂) Rating	
	Current	Potential	
Very energy efficient - lower running costs			Very environmentally friendly - lower CO ₂ emissions
(92 plus) A			(92 plus) A
(81-91) B			(81-91) B
(69-80) C			(69-80) C
(55-68) D			(55-68) D
(39-54) E			(39-54) E
(21-38) F			(21-38) F
(1-20) G			(1-20) G
Not energy efficient - higher running costs			Not environmentally friendly - higher CO ₂ emissions
England & Wales	EU Directive 2002/91/EC	76	England & Wales
		81	EU Directive 2002/91/EC

Viewing

Please contact our office using the details provided at the bottom of this page if you are interested in booking a viewing or require further information.

NOTICE: Stephenson Browne for themselves and for the vendors or lessors of this property whose agents they are give notice that: (1) the particulars are set out as a general guideline only for the guidance of intending purchasers or lessees, and do not constitute, nor constitute part of, an offer or contract; (2) all descriptions, dimensions, references to condition and necessary permissions for use and occupation, and other details are given in good faith and are believed to be correct but any intending purchasers or tenants should not rely on them as statements or representations of fact but must satisfy themselves by inspection or otherwise as to the correctness of each theme; (3) no person in the employment of Stephenson Browne has any authority to make representation or warranty whatever in relation to this property. (4) fixtures & fittings are subject to a formal list supplied by the vendors solicitors. **Referring to:** Move with Us Ltd **Average Fee:** £123.64

T: 01270 763200 E: sandbach@stephensonbrowne.co.uk

www.stephensonbrowne.co.uk